

# CITY OF NORWOOD

Permit No. \_\_\_\_\_

4645 Montgomery Road, Norwood, Ohio 45212

Phone 513-458-4510 Fax 513-458-4511

## BUILDING/ZONING PERMIT APPLICATION

Associated BP # \_\_\_\_\_

1. STREET ADDRESS & SUITE #: \_\_\_\_\_ (Name of Business) \_\_\_\_\_

2. ZONING: \_\_\_\_\_ OCCUPANCY: \_\_\_\_\_ PARCEL NUMBER: \_\_\_\_\_

3.  Residential Property (RCO)  Commercial Property (OBC)

	NAME	STREET ADDRESS	CITY	STATE	ZIP	PHONE/FAX
OWNER						
CONTRACTOR						
PLANS BY						

### 4. TYPE OF IMPROVEMENT

- New Building
- Alteration
- Addition
- Repair/Replacement
- Change of Use
- Change of Occupancy
- Fire Alarm
- Fire Suppression
- Garage
- Hood System
- HVAC # of Units: \_\_\_\_\_
- \_\_\_\_Furnace      \_\_\_\_Air Conditioner
- \_\_\_\_Commercial      \_\_\_\_Residential
- \_\_\_\_Replacement      \_\_\_\_New
- \_\_\_\_Electric      \_\_\_\_Gas      \_\_\_\_Oil
- \_\_\_\_New System; drawings & specs required
- Deck
- Pool (Above-Ground)
- Pool (In-Ground)
- Fence
- Shed
- Sign ID:\_\_\_\_ SQ FT: \_\_\_\_\_
- Wrecking/Moving
- Other (specify) \_\_\_\_\_

5. DESCRIPTION OF WORK: \_\_\_\_\_

6. COST: Estimate cost of construction/improvement for which this application is being made: \$ \_\_\_\_\_

### 7. USE OF THIS BUILDING AND PREMISES:

Existing Use: \_\_\_\_\_  Proposed Use: \_\_\_\_\_

8. TOTAL FLOOR AREA FOR NEW BUILDINGS/GARAGES/SHEDS/ADDITIONS/DECKS: \_\_\_\_\_

The owner of this building and undersigned, do hereby covenant and agree with all the laws of the State of Ohio and the ordinances of the City of Norwood pertaining to building(s), and to construct the proposed building(s) or structure(s) or make the proposed change or alteration in accordance with the plans and specifications submitted herewith, and certify that the information and statements given on this application, drawings and specifications to the best of their knowledge, true and correct.

Application by \_\_\_\_\_ Date: \_\_\_\_\_  
Owner or Agent's Name (Print & Sign) (phone number)

### DO NOT WRITE BELOW THIS LINE (Office Use Only)

Required Review/upfront Fee \$ \_\_\_\_\_

Permit or Zoning Fee \$ \_\_\_\_\_

Fine \$ \_\_\_\_\_

OBC 3% (Commercial) \$ \_\_\_\_\_

RCO 1% (Residential) \$ \_\_\_\_\_

**Total** \$ \_\_\_\_\_

**Balance Due** \$ \_\_\_\_\_

Payment: Cash Check Credit Card Receipt # \_\_\_\_\_

Plans Examiner Approval: \_\_\_\_\_ Date Plans Approved: \_\_\_\_\_

Construction Type: \_\_\_\_\_ Use Group: \_\_\_\_\_

Building/Zoning Official Approval \_\_\_\_\_ Date Permit Issued: \_\_\_\_\_

**CITY OF NORWOOD**  
BUILDING DEPARTMENT  
4645 MONTGOMERY ROAD, NORWOOD OHIO 45212  
(513) 458-4510 FAX (513) 458-4511

## HEATING AND COOLING DATA SHEET

TO BE SUBMITTED ALONG WITH RESIDENTIAL HVAC APPLICATION

### ① DESCRIPTION OF EXISTING CONDITIONS:

- A. Type of heating system:     Forced Air    Gravity    Steam    Water    Other \_\_\_\_\_
- B. Fuel type:                       Natural Gas    Electric    Propane    Other \_\_\_\_\_
- C. Existing Venting:               Interior Chimney    Exterior Chimney    "B" Vent    Direct Vent    Other \_\_\_\_\_
- D. Does the existing heating system contain hazardous material?    YES         NO
- E. Is the existing furnace located in habitable areas?                       YES         NO

### ② DESCRIPTION OF PROPOSED WORK:

- A. Location of new heating system: \_\_\_\_\_
- B. Type of heating system:  Forced Air    Gravity    Steam    Water    Other \_\_\_\_\_
- C. BTU input rating: \_\_\_\_\_ BTU output rating: \_\_\_\_\_ Efficiency Rating: \_\_\_\_\_
- D. Fuel type:                       Natural Gas    Electric    Propane    Other \_\_\_\_\_
- E. Chimney & Venting System: \_\_\_\_\_
- F. Location of new air-conditioning system: **SITE PLAN REQUIRED:** \_\_\_\_\_
- G. SEER Rating: \_\_\_\_\_ COP Rating: \_\_\_\_\_
- H. Are any existing gas lines to be extended or replaced?    YES     NO

### ③ CONDITIONS OF THE PERMIT:

- A. All flue gases are to be vented in accordance with the manufacturer's instructions.
- B. The location of exhaust vents from windows and air intakes must be in accordance with the manufacturer's instruction and/or the Residential Code of Ohio.
- C. The manufacturer's installation instructions and operation instructions are to be permanently attached to the units
- D. All furnaces are to be supplied by dedicated circuit, **PERMIT BY IBI REQUIRED.**

**NOTE:** The new **2013 Residential Code of Ohio; Chapter 3 Building and Planning** requires that carbon monoxide alarms be installed per:

#### **SECTION 315**

#### **CARBON MONOXIDE ALARMS**

**315.1 Carbon monoxide alarms.** For new construction, an approved carbon monoxide alarm shall be installed outside of each separate sleeping area in the immediate vicinity of the bedrooms in dwelling units within which fuel-fired appliances are installed and in dwelling units that have attached garages.

**315.2 Where required.** Where work requiring a permit occurs in existing dwellings that have attached garages or in existing dwellings within which fuel fired appliances exist, carbon monoxide alarms shall be provided in accordance with Section 315.1.

**315.3 Alarm requirements.** Single station carbon monoxide alarms shall be listed as complying with UL 2034 and shall be installed in accordance with this code and the manufacturer's installation instructions.

NORWOOD BUILDING DEPARTMENT  
PLOT/SITE PLAN

ADDRESS \_\_\_\_\_

PERMIT # \_\_\_\_\_

LOT WIDTH \_\_\_\_\_ DEPTH \_\_\_\_\_

- A. Show set back dimension
- B. Show distance from property line and adjacent buildings
- C. Show dimensions of and setbacks for *existing* and *proposed* structures, additions, driveways, sheds and fences

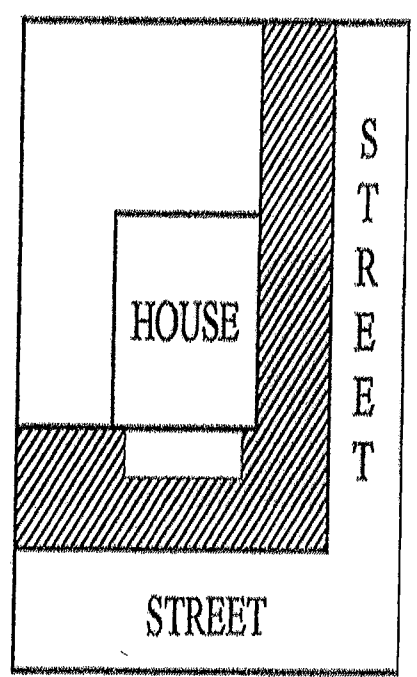
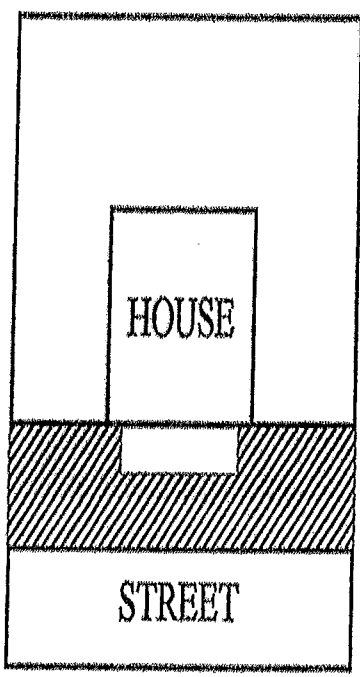
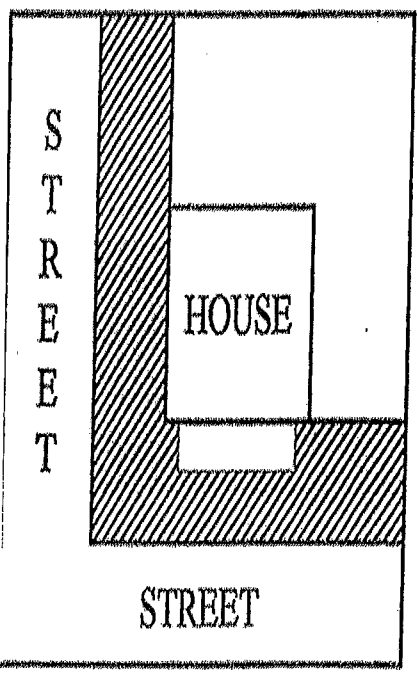

\_\_\_\_\_ Address

\_\_\_\_\_ Name

\_\_\_\_\_ Signature

\_\_\_\_\_ Date